

46

PACIFIC ELECTRIC RAILWAY COMPANY ORM 4479-76
TO
COUNTY OF LOS ANGELES 46

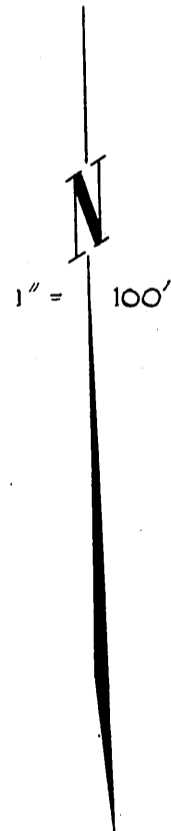
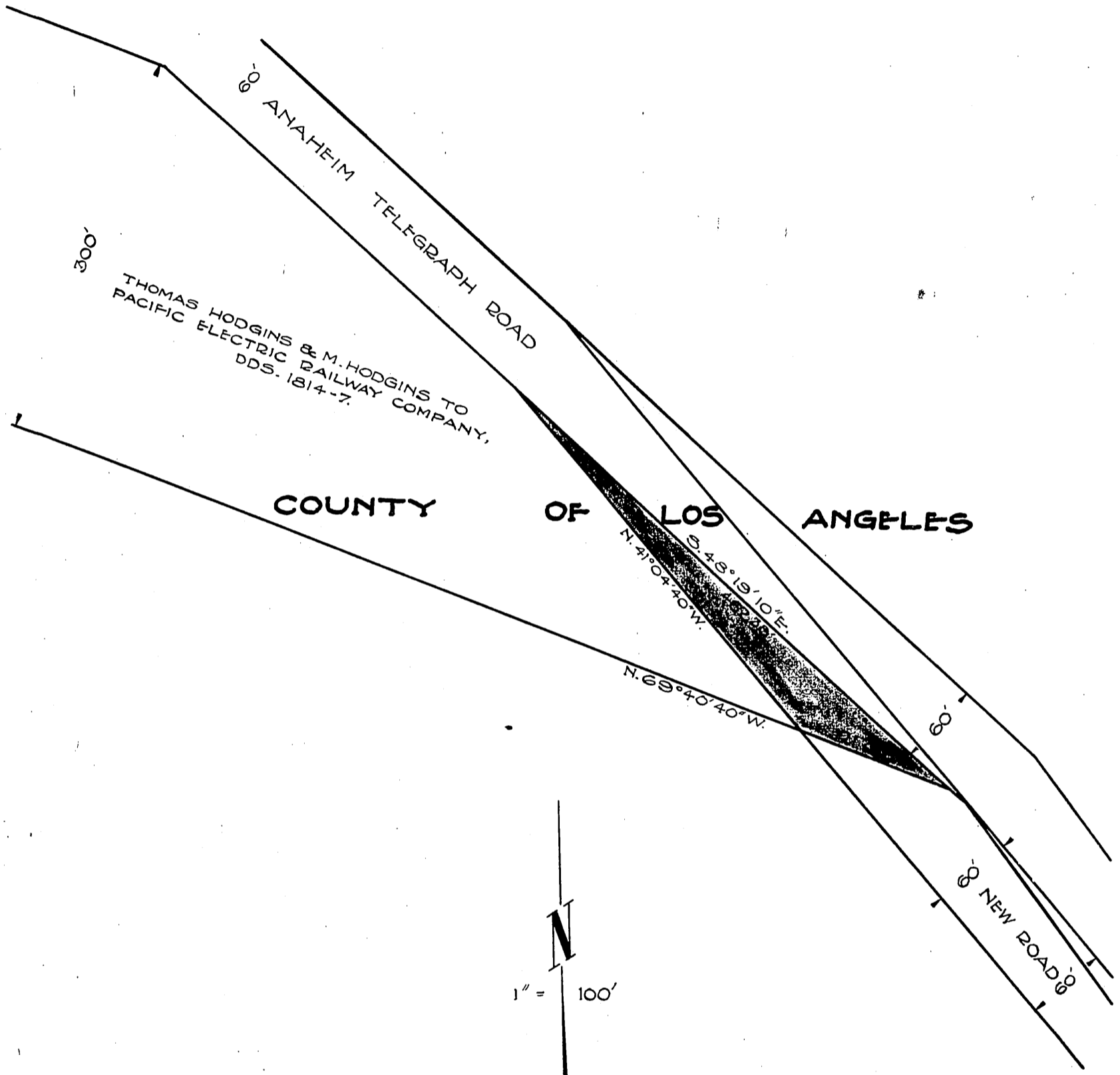

C.E.K. 1021-a

COMP. F.C.K.
C.E.M.

Shi. 26

C. S. 8591
D: 45-232

RECORDED JULY 3, 1925

O.R. 4479