

51

PACIFIC ELECTRIC RAILWAY COMPANY  
TO  
COUNTY OF LOS ANGELES

ORM-4500-206

51

COUNTY OF LOS ANGELES

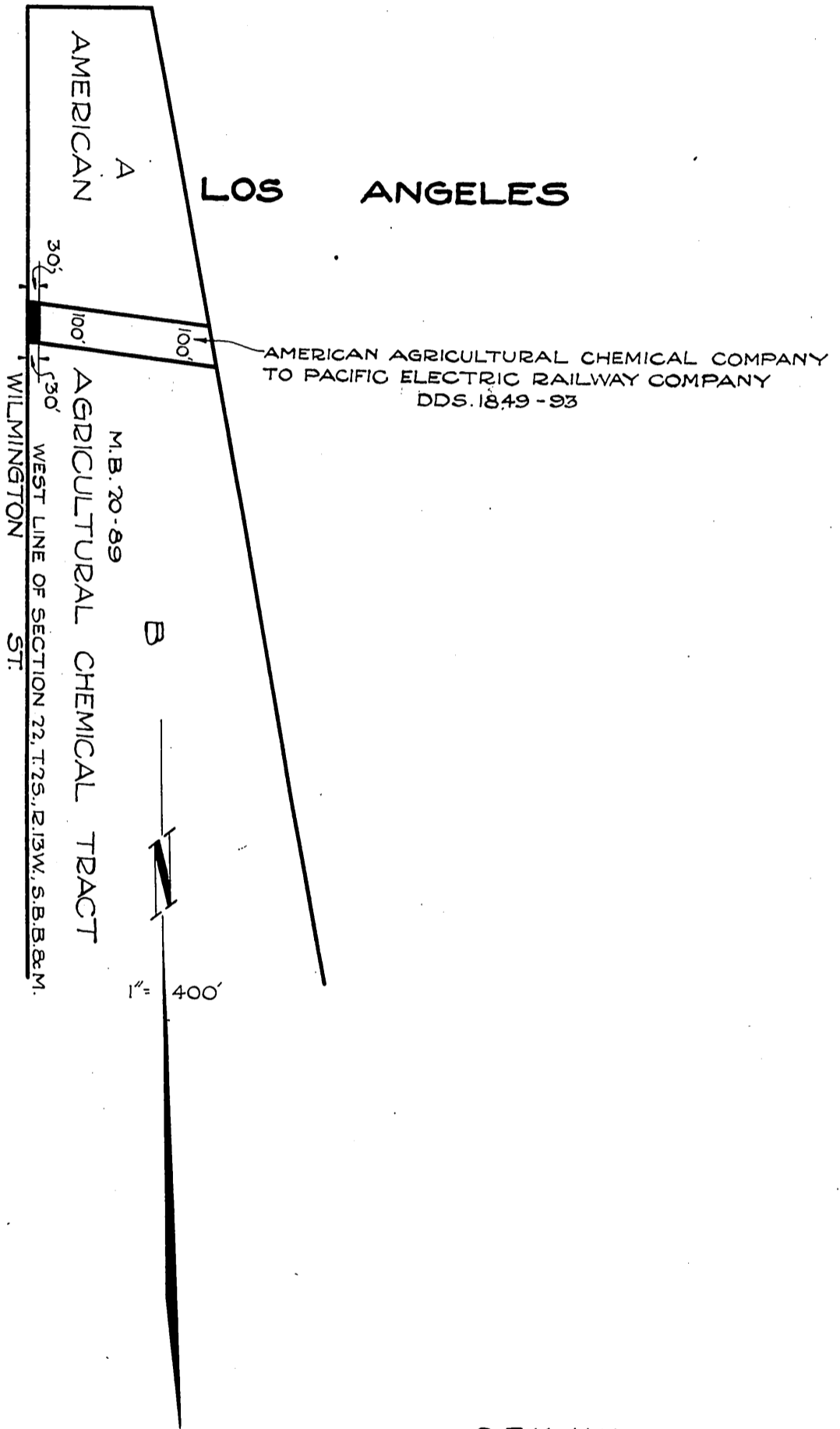

1111

C.E.K. 1111

COMP. F.C.K.  
H.G.

SEP 7  
A. 1111

RECORDED SEPT. 4, 1925

O.R. 4500