

ORM 4750-165  
26

PACIFIC ELECTRIC RAILWAY COMPANY  
TO  
CITY OF LOS ANGELES

CITY OF LOS ANGELES

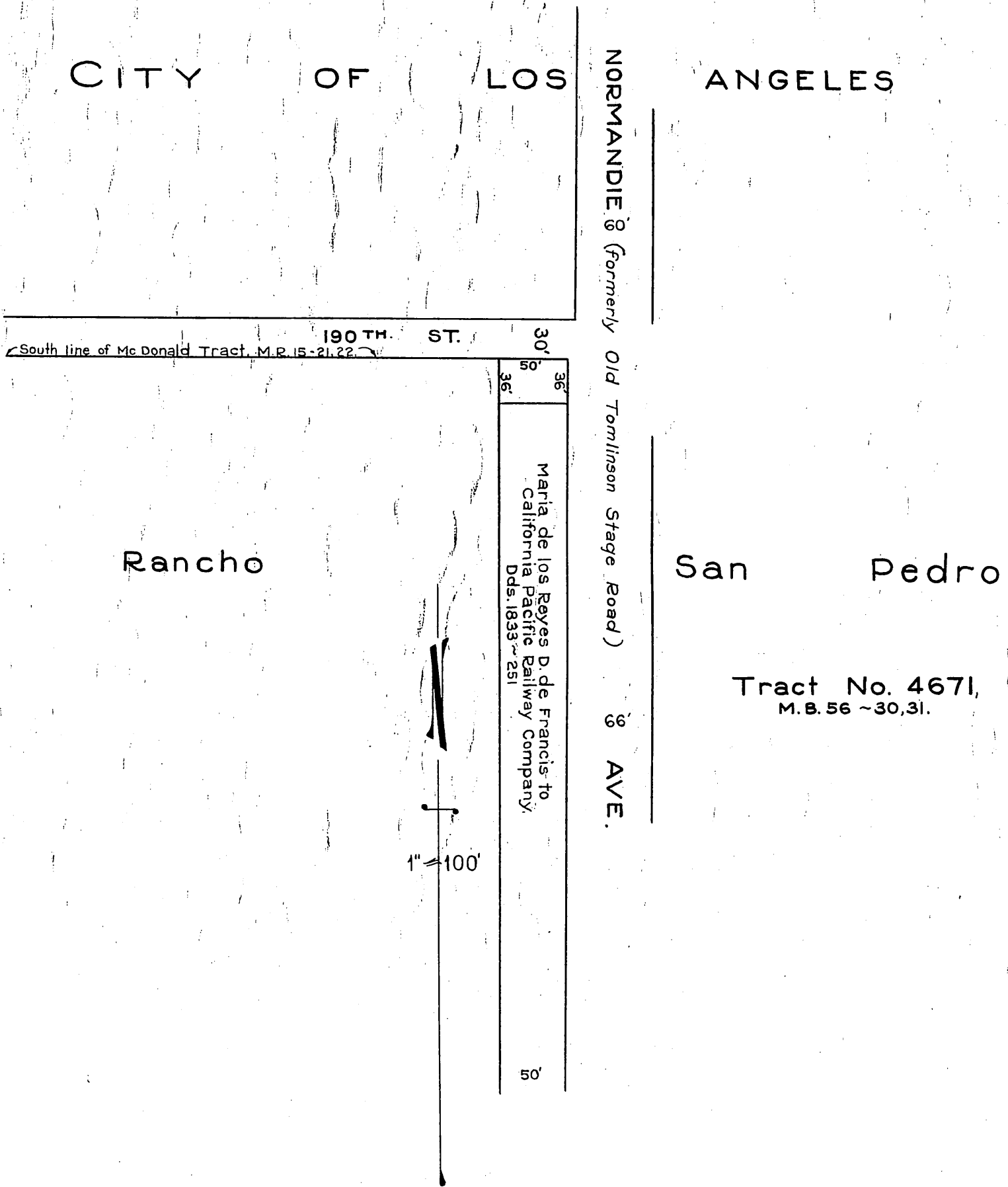

South line of McDonald Tract, M.P. 15-21, 22

Maria de los Reyes D. de Francis to  
California Pacific Railway Company  
Dds. 1833-251

Tract No. 4671,  
M. B. 56 ~ 30, 31.

C.E.K. 1321

Comp. L.C.  
R.S.B.

Sta. = 20  
D: 57-100

RECORDED JAN. 21, 1927.

O.R. 4750