

SOUTHERN PACIFIC RAILROAD COMPANY ORM-7009-36
 AND
 SOUTHERN PACIFIC COMPANY 18
 TO
 CITY OF LOS ANGELES

Los Angeles Div.
Drawing F-9795
Sheet 1 of 1
Form 30 L-A

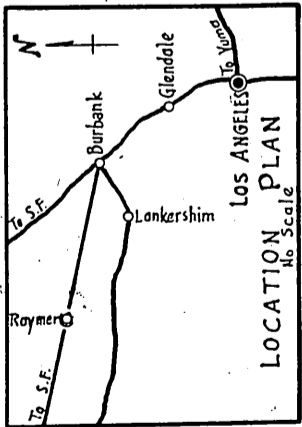
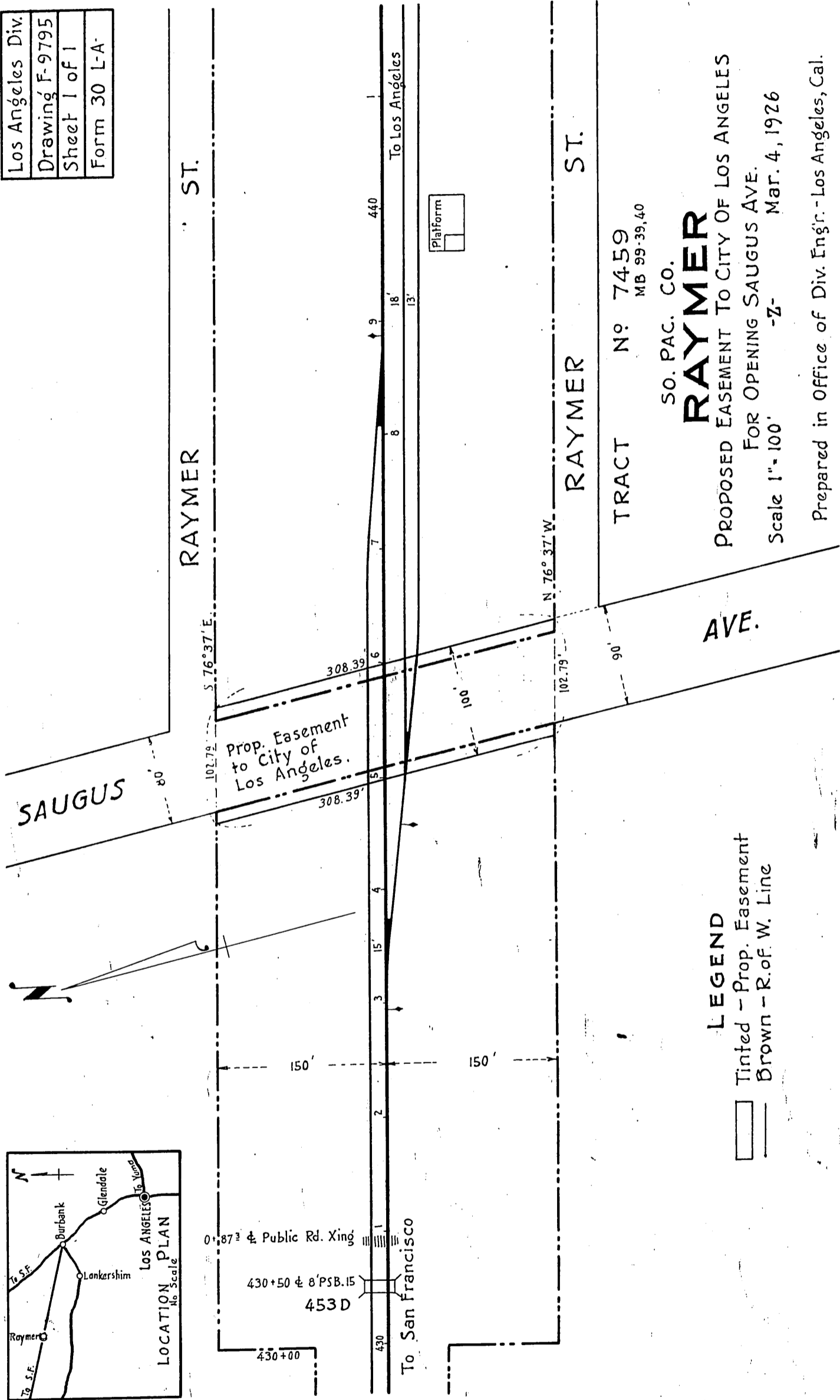

LEGEND

- Tinted - Prop. Easement
- Brown - R. of W. Line

TRACT No 7459
 MB 99-39,40
 SO. PAC. CO.
RAYMER
 PROPOSED EASEMENT TO CITY OF LOS ANGELES
 FOR OPENING SAUGUS AVE.
 Scale 1"=100' -Z- Mar. 4, 1926
 Prepared in Office of Div. Engr. - Los Angeles, Cal.

Comp. EHT
 RSB

SHT. 55

D:57-242.
 RECORDED APR. 28, 1927.

O.R. 7009