

PACIFIC ELECTRIC RAILWAY COMPANY ORM-7727-37
TO
COUNTY OF LOS ANGELES 92

COUNTY OF LOS ANGELES

Tract No. 2517,
M.B. 24-66.

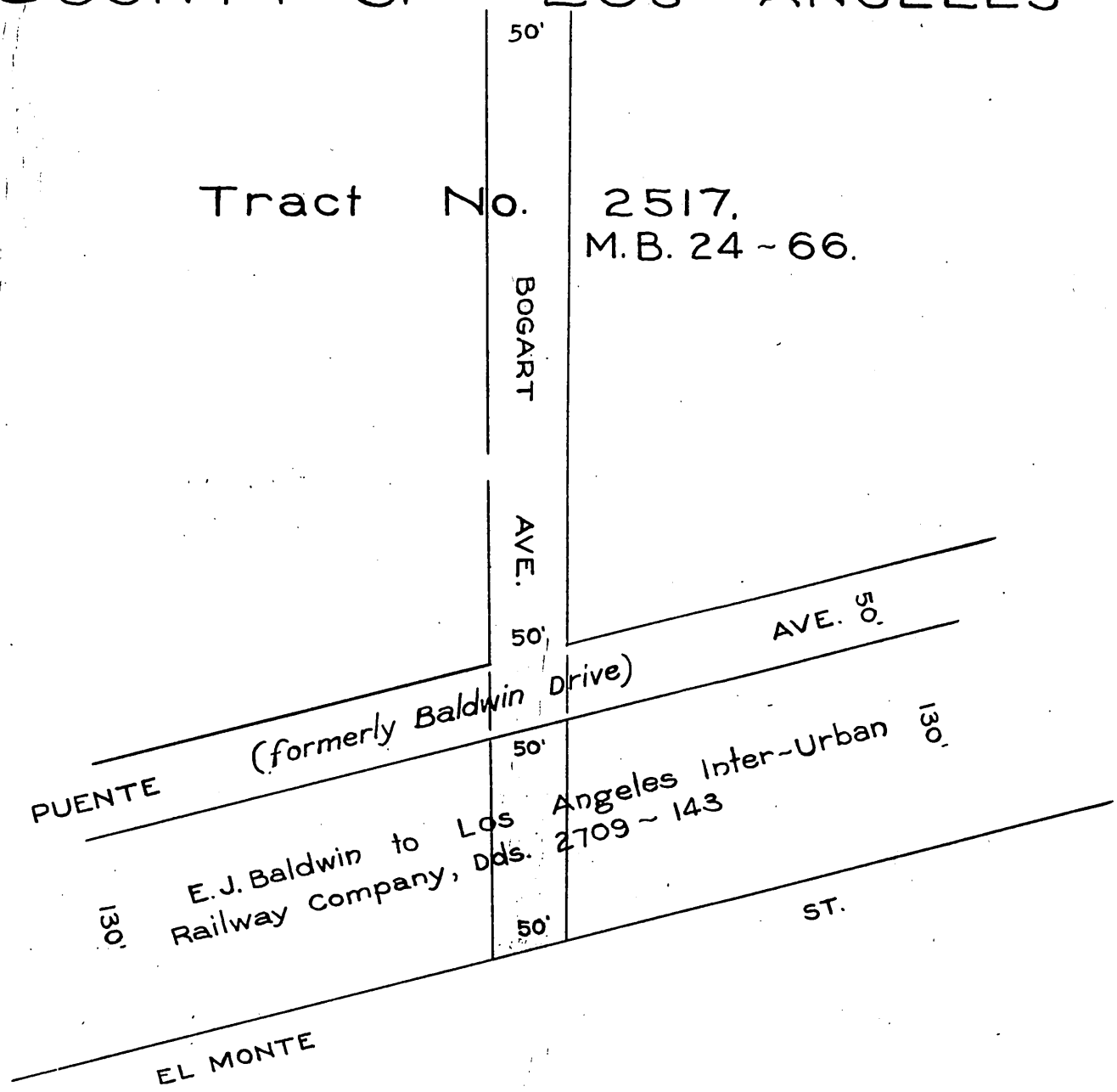

C. E. K. 1309

Puente Ave. and El Monte St. changed to San Bernardino Rd. D:49-218

Shr. 46

D:63-107

RECORDED SEPT. 22, 1927.

L. C.
Comp. R. S. B.

A-107

O.R. 7727