

Aggregate Area of Public Lands
23090.90 acres

Meridians, not otherwise noted, run at a var. of 14° 08' East.

Surveys Designated	By Whom Surveyed	Date of Contract	Amount of Surveys			When Surveyed
			Mis.	Chs.	Trs.	
Township Lines	E. W. Norris	December 23 rd 1854	24	00	88	1855
Section	.	October 19 th 1855	60	07	27	1856

Signed:-

John C. Hays

Surv. Gen'l Cal.

E. bdy. of Twp. see C. S. 9135
W. " " " " " " C. S. 9151

N. Bdy. of Twp. see C. S. 9107 (C. Line)
N. Bdy. of Twp. C. S. 9124

Interior line & part of S. bdy. of South Bay C. S. 9169

Signed:-

J. W. Mandeville

Surv. Gen'l Cal.

TOWNSHIP 8 NORTH, RANGE 8 WEST, OF THE SAN BERNARDINO MERIDIAN, CALIFORNIA.
 SUPPLEMENTAL PLAT

T. 8 N.
 R. 8 W.
 ②

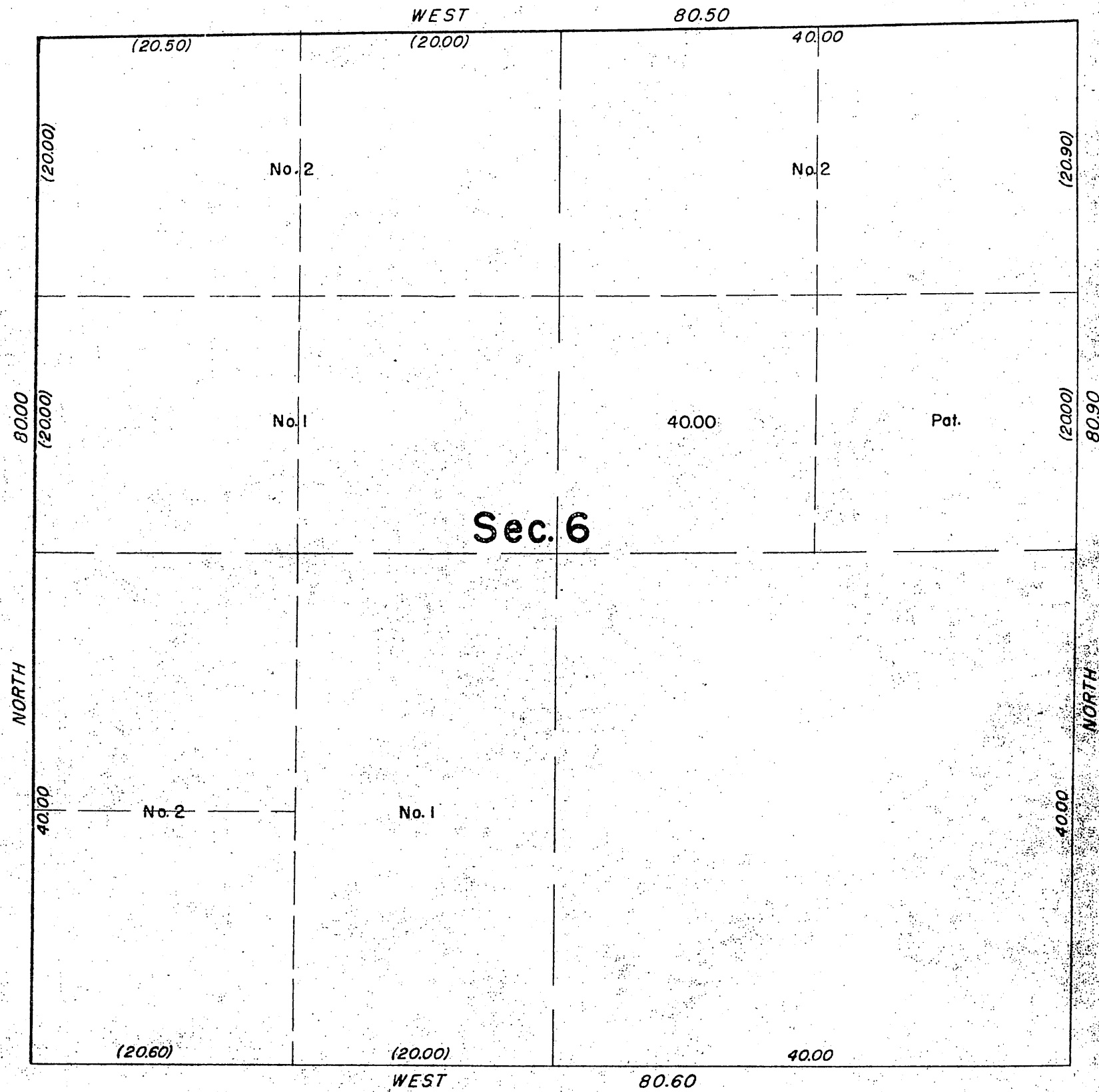

This supplemental plat of sec. 6, T. 8 N., R. 8 W., S.B.M., California, is prepared to show the $W\frac{1}{2}$ lot 1 of the $NE\frac{1}{4}$ as the normal $SW\frac{1}{4}NE\frac{1}{4}$, containing 40.00 acres, based on plat approved September 19, 1856.

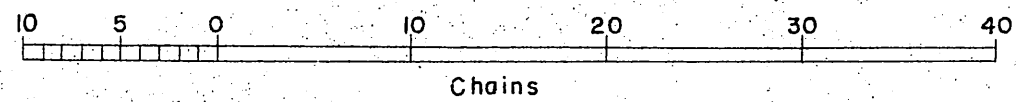

UNITED STATES DEPARTMENT OF THE INTERIOR
 BUREAU OF LAND MANAGEMENT
 Washington, D.C. June 13, 1960

This plat, showing amended lottings, is based upon the official records, and having been correctly prepared in accordance with the regulations, is hereby accepted.

For the Director

[Handwritten Signature]

Cadastral Engineering Staff Officer