

TOWNSHIP N° 8 SOUTH , RANGE N° 15 WEST , SAN BERNARDINO MERIDIAN , CALIFORNIA

RECEIVED  
U. S. LAND OFFICE  
LOS ANGELES, CALIF.  
Date MAY 27 1927  
Hour 12<sup>00</sup>

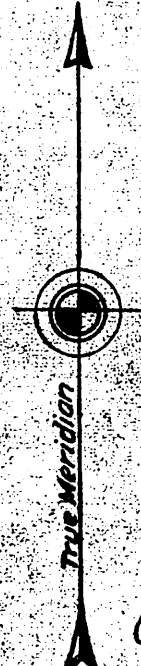
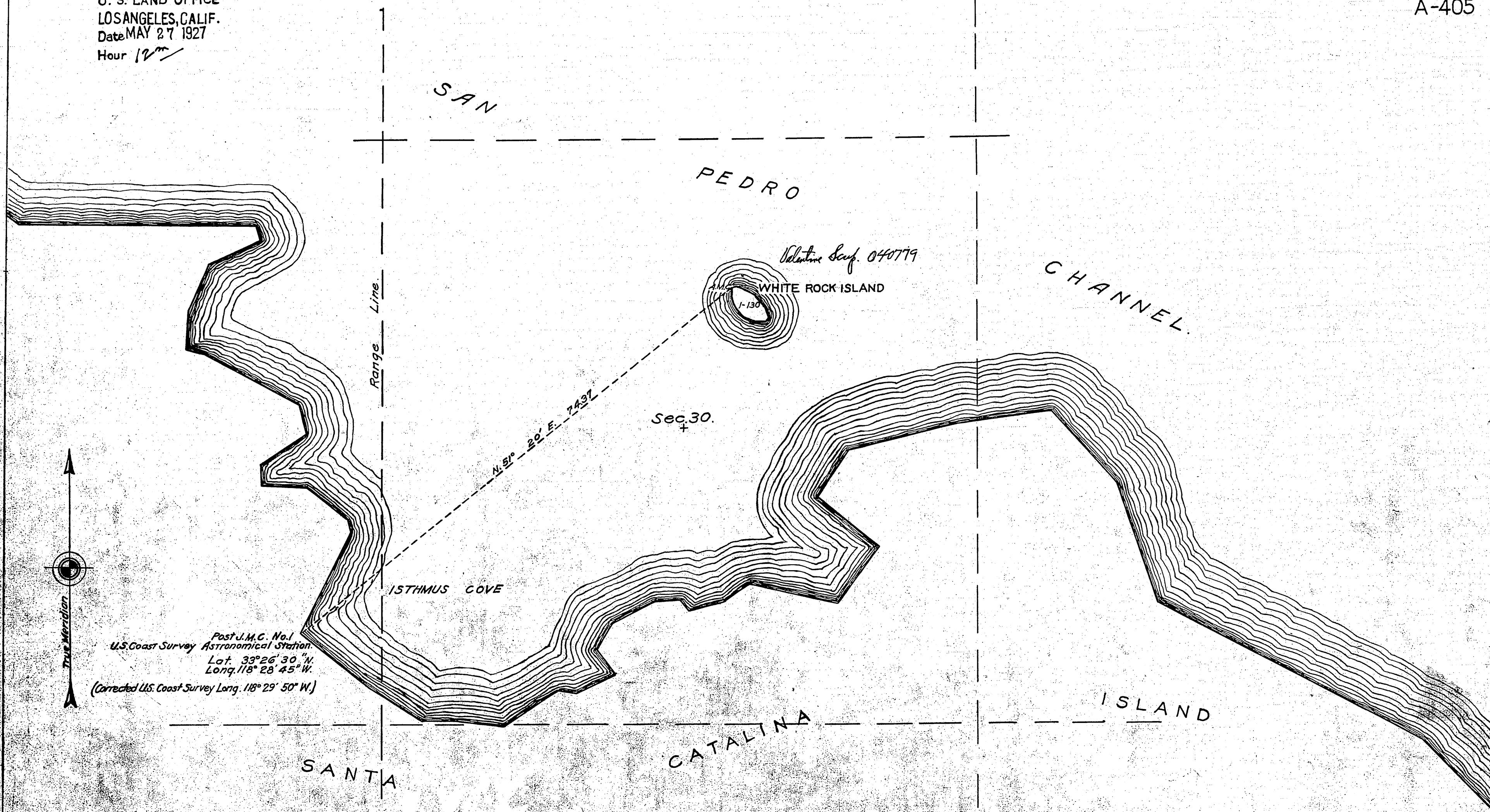

Post J.M.C. No. 1  
U.S. Coast Survey Astronomical Station  
Lat.  $33^{\circ} 26' 30'' N.$   
Long.  $118^{\circ} 28' 45'' W.$   
(Corrected U.S. Coast Survey Long.  $118^{\circ} 29' 50'' W.$ )

Filed in U. S. Land Office,  
Los Angeles, Cal.  
AUG 10 1927  
Register

Scale: 10 Chains to an Inch

Area Surveyed, 1.30 Acres

Office of U.S. Supervisor of Surveys  
Denver, Colorado, February 15, 1927  
The above plat of White Rock Island in approximate  
Section 30, Township No. 8 South, Range No. 15 West  
of the San Bernardino Meridian, California, is  
strictly conformable to the field notes of the survey  
thereof which have been examined and approved.

DEPARTMENT OF THE INTERIOR  
GENERAL LAND OFFICE  
Washington, D.C., March 4, 1927  
The survey represented by this plat  
having been correctly executed in accordance  
with the requirements of law and the regulations  
of this office, is hereby accepted.

Mean Magnetic Declination

LINES DESIGNATED	BY WHOM SURVEYED	GROUP NO.	DATE	MILEAGE		WHEN SURVEYED	
				MLS.	CHS.	BEGUN	COMPLETED
Exterior							
Subdivisional							
Meander	Wm. H. Thorn, U.S. Cadastral Engineer	64	June 24, 1926	14.53		Sept. 20, 1926	Sept. 21, 1926
Miscellaneous							

*Montford Johnson*  
U.S. Supervisor of Surveys

Letter C 1713484  
Authorizing filing of the plat

*Thoreston*  
Assistant Commissioner

Traced by Gus N. July 1, 1930  
Checked by R.S.B. July 1, 1930